

TRAPICHE MASSARAPUÁ
ESC.: 1:100

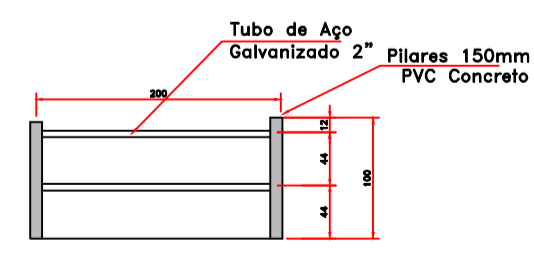

DETALHE GUARDA CORPO MASSARAPUÁ
ESC.: 1:100

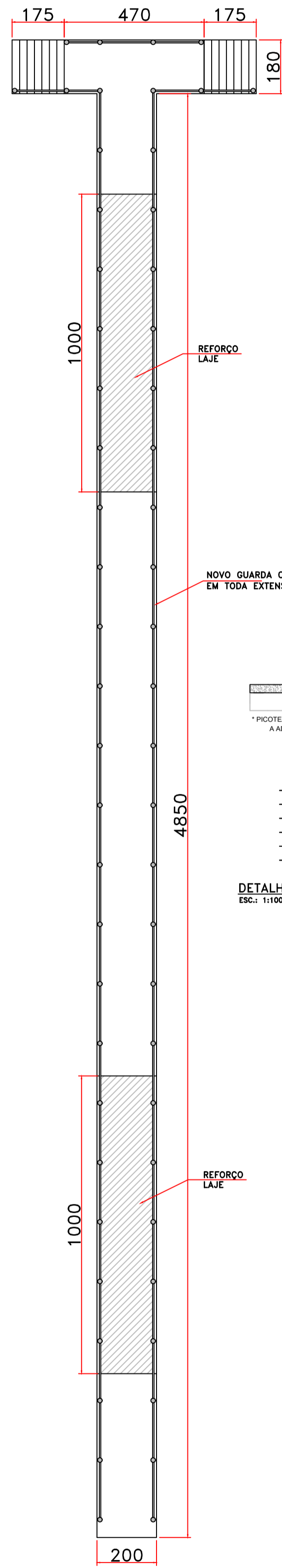

TRAPICHE SEBUÍ
ESC.: 1:100

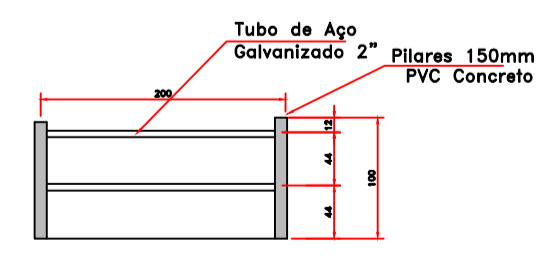

DETALHE GUARDA CORPO SEBUÍ
ESC.: 1:100



DETALHE REFORÇO LAJE
ESC.: 1:100

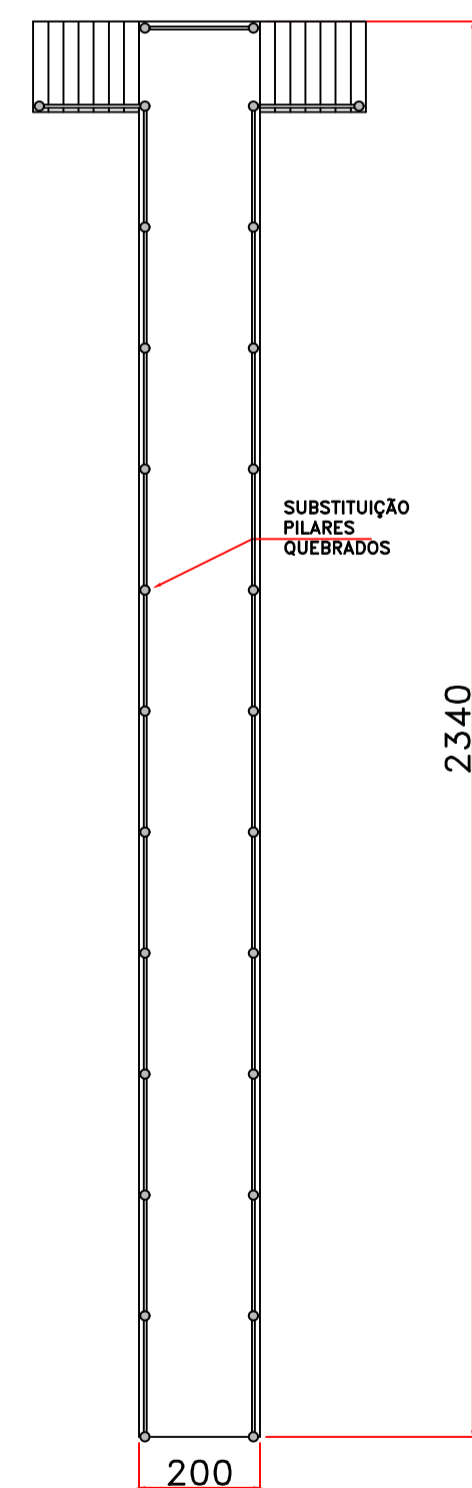

TRAPICHE TIBICANGA
ESC.: 1:100

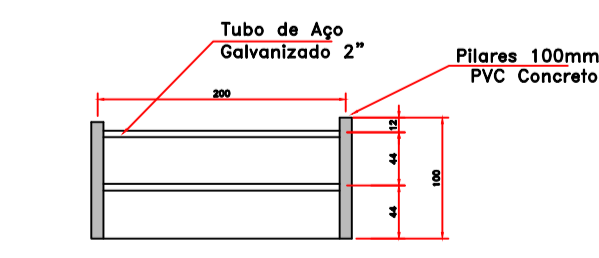

DETALHE GUARDA CORPO TIBICANGA
ESC.: 1:100

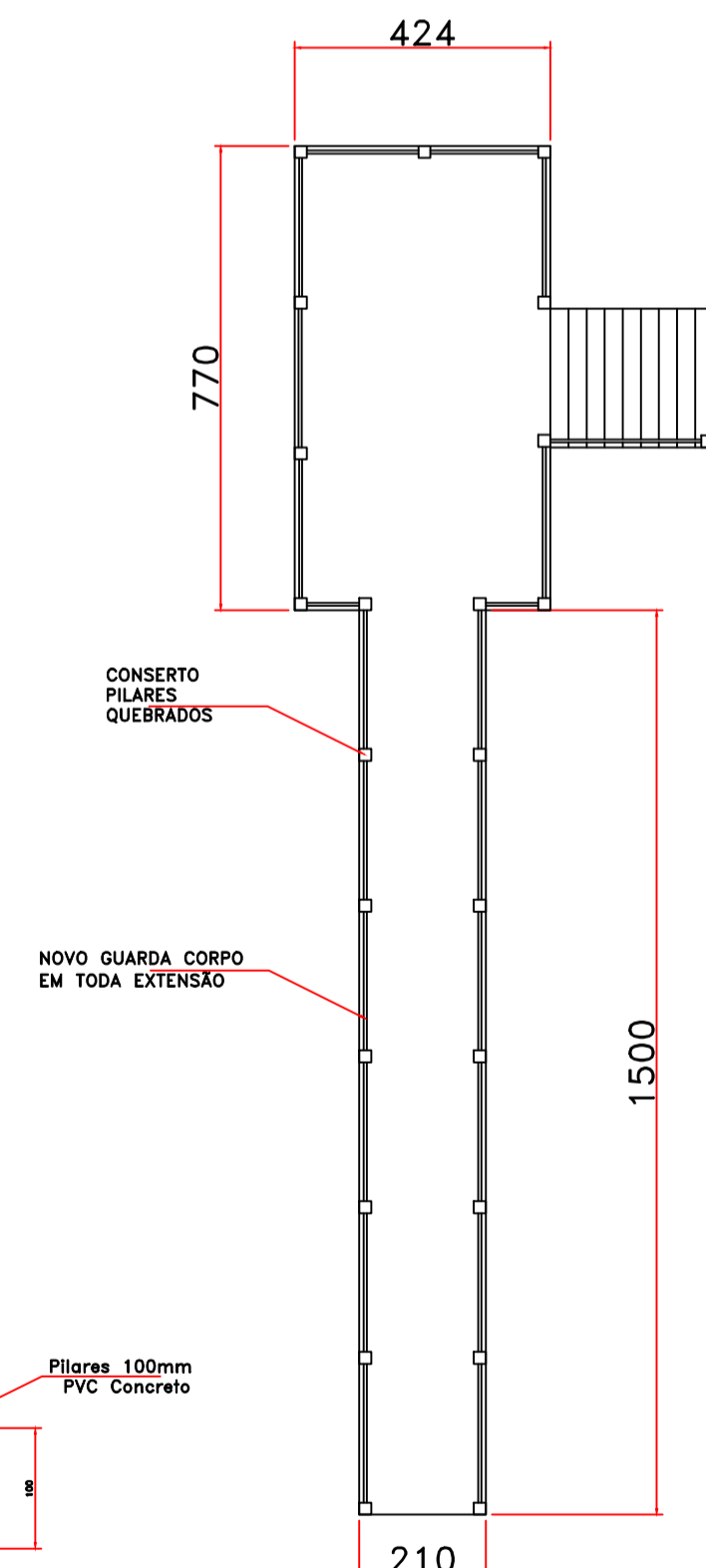

TRAPICHE BARRA ARARAPIRA
ESC.: 1:100

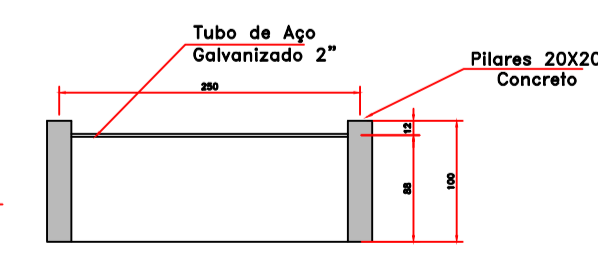

DETALHE GUARDA BARRA ARARAPIRA
ESC.: 1:50

PROJETO EXECUTIVO

PROPRIETÁRIO
PREFEITURA MUNICIPAL DE GUARAQUEÇABA



OBRA
PROJETO DE REFORMA E REVITALIZAÇÃO DE TRAPICHES NO MUNICÍPIO DE GUARAQUEÇABA

DATA JUN/23
ESCALA indicada

CONTEÚDO DA PRANCHA
PLANTA BAIXA, CORTES E DETALHES

Nº PRANCHA
04/08

AUTOR DO PROJETO

Carlos H. S. Marquardt
Engenheiro Civil - CREA 65783/D-PR

